

Caseement Windows

with X-Drive System by **Joyce**[™] mfg. co.



Features & Benefits:

- Effortless functionality and minimized operating force with ergonomically engineered crank handle and operator system.
- Integrated corner drive delivers seamless additional locking points, enhancing security and structural integrity.
- Adjustable lock pins and operators allow for a precise, tailored fit in every opening.
- Premium engineered hardware designed for long-lasting performance, creating a superior seal that virtually eliminates air and water infiltration.

Lockout Crank Handle

- Locks in place with audible “click” when operating for more stability.
- Made with zinc hardware for extra durability and corrosion resistance.
- Sleek, modern design tucks neatly into cover cap when not in use for a clean, streamlined appearance.

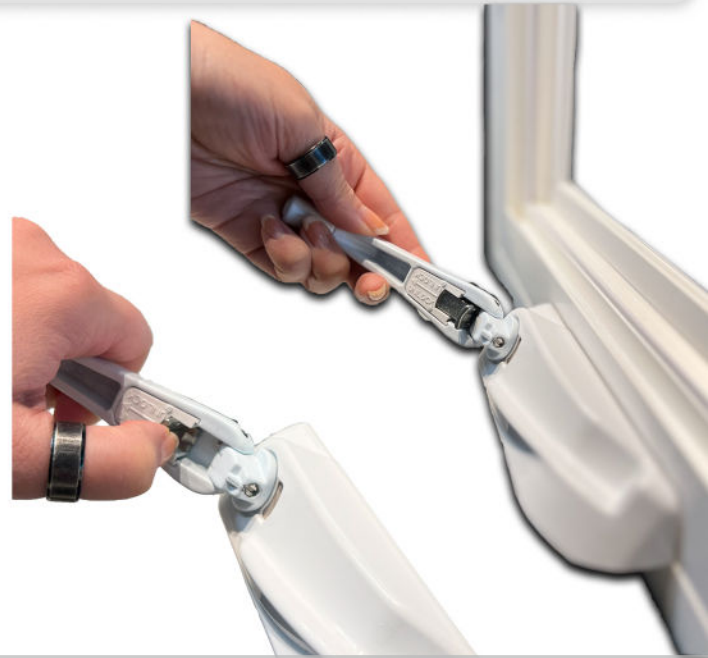

Handle Color Options



White



Black



Beige



Satin



Bronze



Corner Drive

- Additional head lock bar improves sealing and for security at the top of the frame.
- Positioned opposite of hinge, providing a dedicated locking point 3" from top corner.
- Integrates seamlessly with the full-length lock and tie bar assembly for smooth, reliable operation.
- Boosts structural performance with added locking engagement.
- Standard on sizes 94 united inches and larger, available as an optional upgrade for smaller sizes. Required if height >60 in or >93UI.

Lock bar and handle

- Adjustable lock pins allow post-installation compression adjustments for a customized fit.
- Patented mushroom pin design prevents disengagement from strikers, enhancing reliability.
- Audible "click" and multiple locking points provide added safety and security.
- Durable composite strikers ensure smooth, metal-free engagement and long-term strength.
- Handle includes integrated gaskets for a tight seal and improved air infiltration control.



Operator

- Bi-directional fastening system (four vertical and two lateral screws) ensures stability and eliminates rocking during operation.
- Smooth, effortless operation with reduced force required at the crank handle.
- Durable powder-coated finish resists corrosion, while low-friction components minimize effort during use.
- Easily adjusts with Allen wrench for convenience and precision.
- Roller sash lift realigns the sash smoothly back into position, ensuring square operation and reducing drag if any misalignment occurs.